

Altro PVCu wall sheet to quarry tile floor detail

typical specification (Ref: WF3)

Altro PVCu wall sheet 2.5mm thick installed over most sound, dry substrates, to quarry tile skirting (typical 100mm by 12mm thick with similar floor tiles) fixed with the appropriate

AltroFix™ adhesive and double sided tape (A815) sealed with silicone sealant (A802 or A805).

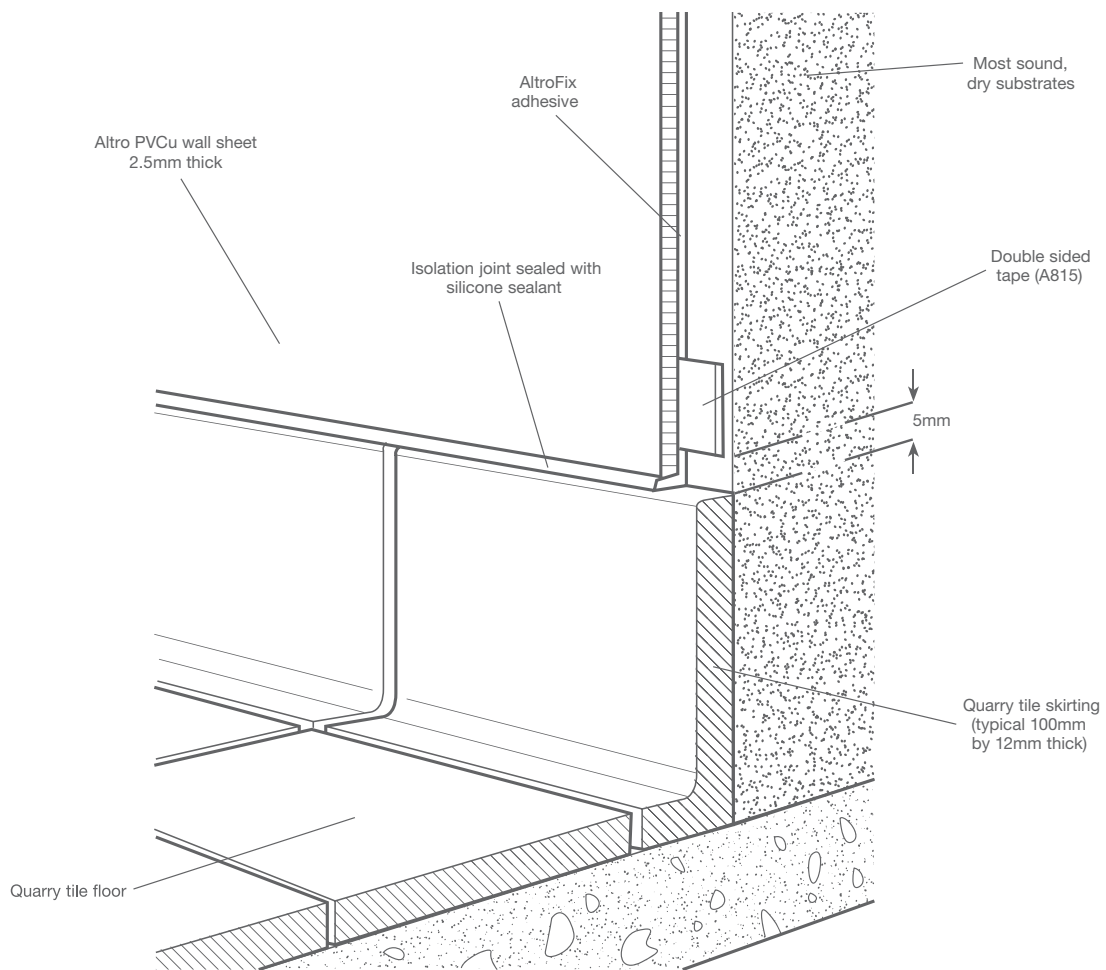

For further information or technical advice

tel: 01462 707600

email: enquiries@altro.com or www.altro.com